

# CARMIX 45FX

**CARMIX**  
4x4 mixers & dumpers

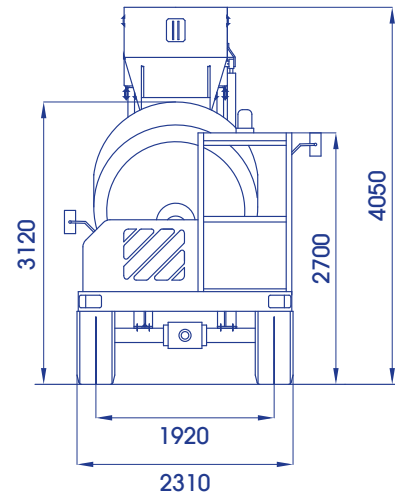
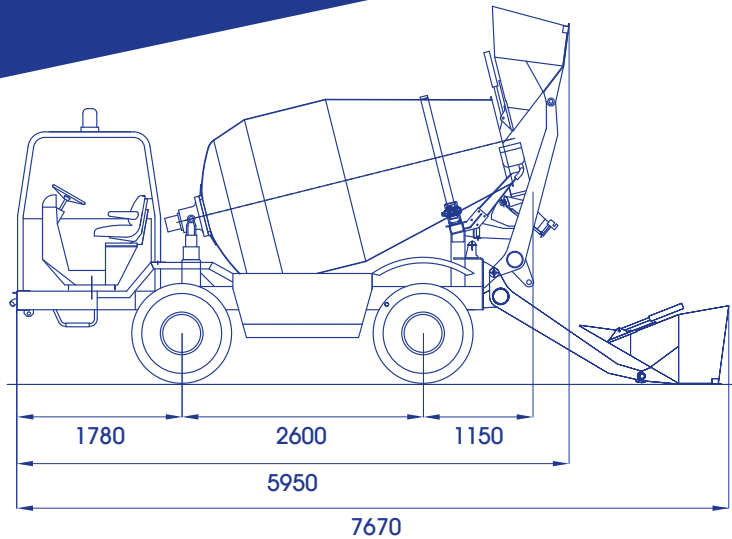

## ACCESSORIES ON DEMAND

Electronic weighing system "LOAD CELLS" with printer

High-pressure washing pump

Rear camera (front camera standard)

Spare wheel

# CARMIX 45FX



## MIXING UNIT

Drum capacity 6050 liters. Concrete drum output: 4,5 m<sup>3</sup>. Double mixing screws, cover for emergency unloading. Drum rotation by hydraulic motor and planetary reducers. Mixing and discharging speed independent from r.p.m. of diesel engine. Discharging by reversing drum.



## ENGINE

Perkins 1104D - 44TA Turbo-Diesel Tier 3, water-cooled, 4 cylinders Tier 3. Power 83 kW (111 HP) set at 2200 rpm.



## TRANSMISSION

Hydrostatic Bosch-Rexroth. Heavy duty differential axles with planetary reducers. Front axle swinging and steering. Rear axle fixed.



## AXLES

Come with oil bath disc brakes and planetary reducers.



## SPEED

Working speed from 0 to 10 km/h, road transfer from 0 to 25 km/h. Electric servo control.



## DRIVING SEAT

ROPS-FOPS canopy. Reversible seat with automatic inversion of hydraulic steering circuit. Closed cabin on request. Air conditioning on request.



## HYDRAULIC SYSTEM

3 independent circuits. 2 variable outlet pumps for hydrostatic transmission and drum rotation. 1 pump for services. Inlet and outlet filter. Heat exchanger water/oil-air type.



## WEIGHING

Electronic system. "Load cells" acting on the drum, display and printer in the cab. (on request)



## LOADING SHOVEL SELF ARTICULATED

Effective capacity per load 600 liters, complete with hydraulic opening gate.



## CHUTE

Slewing and hydraulically tilting 2 extra chutes included.



## WATER SYSTEM

Self-contained. Hydraulic driven water pump, water meter, washing outlet.



## GRADIENT

A pieno carico 30%.



## BRAKES

Oil bath disc brakes inside differential axles. Twin independent circuits. Negative hydraulic parking brake.



## TYRES

Off road industrial type 16/70-20 PR14.



## STEERING

Hydrostatic. 3 wayS steering. Radius: internal mm. 1800 - external mm. 3800.



## ELECTRIC SYSTEM

12 Volt. 120 Ah battery for electric starter and road lighting. Safety battery cut-off.



## TANKS

Water: 2x590 liters. Diesel: 130 liters. Hydraulic oil: 80 liters.



## CHASSIS

Steel profile specially engineered for off-road operations.



## WEIGHT

In running order Kg. 7000 equally distributed on both axles.



## SAFETY

Machine equipped with checking and block valves for maximum safety of the operator.



## CATALOGUE

The machine is equipped with Use and Maintenance and Spare Parts manuals according to CE regulations

**CARMIX**  
**EVERYWHERE**  
**YOU BUILD**